

- En **Instruction Manual**
- De **Bauanleitung**
- Fr **Manuel de montage**
- 日本語 **取扱説明書**

# nitro rs4 **RTR3 DRIFT**



**HPI**  
RACING

# 6 Exploded View Explosionszeichnung

# Vue éclatée 展開図

## Chassis Assembly Chassis

## Montage du châssis シャーシ展開図

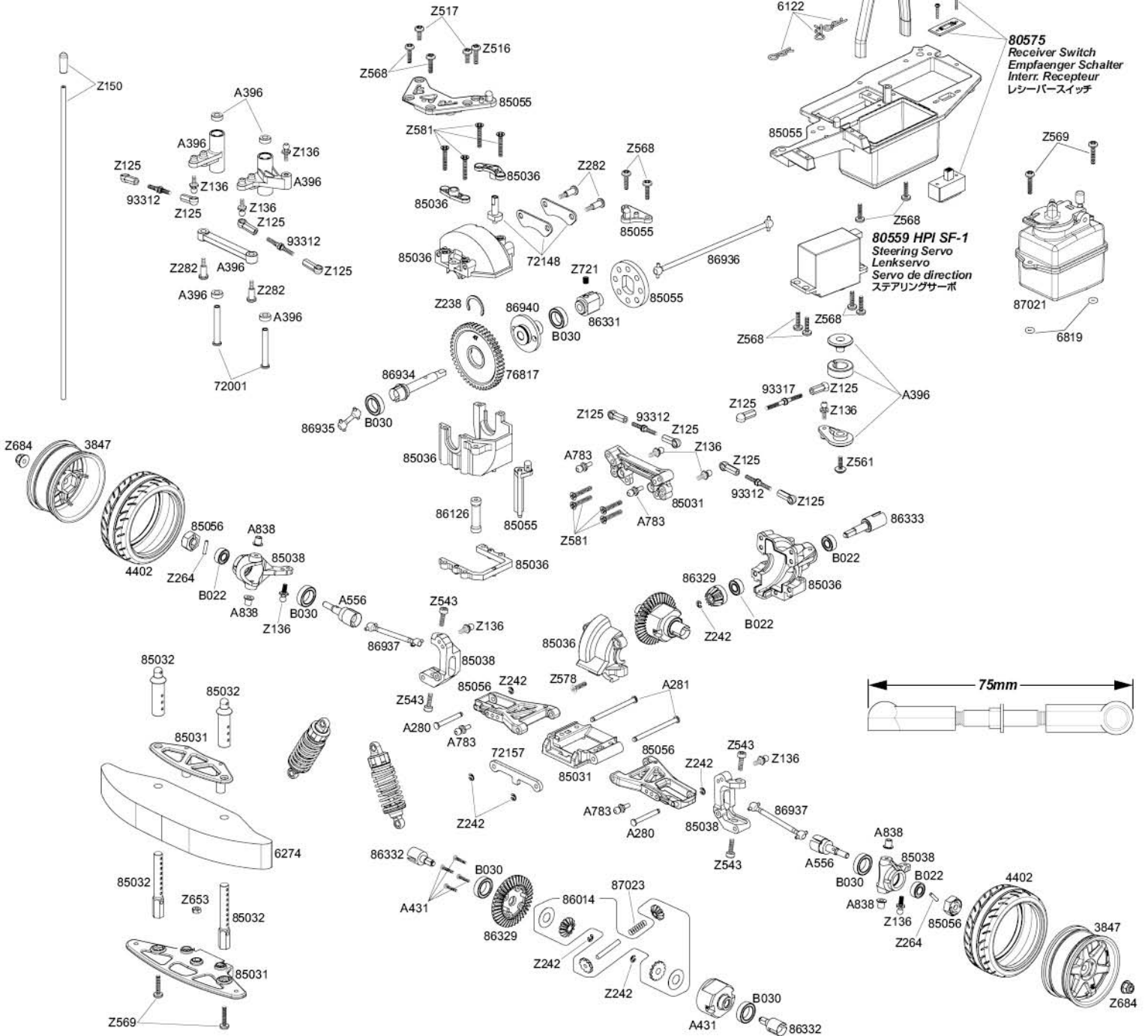
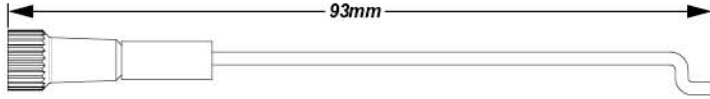
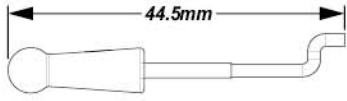

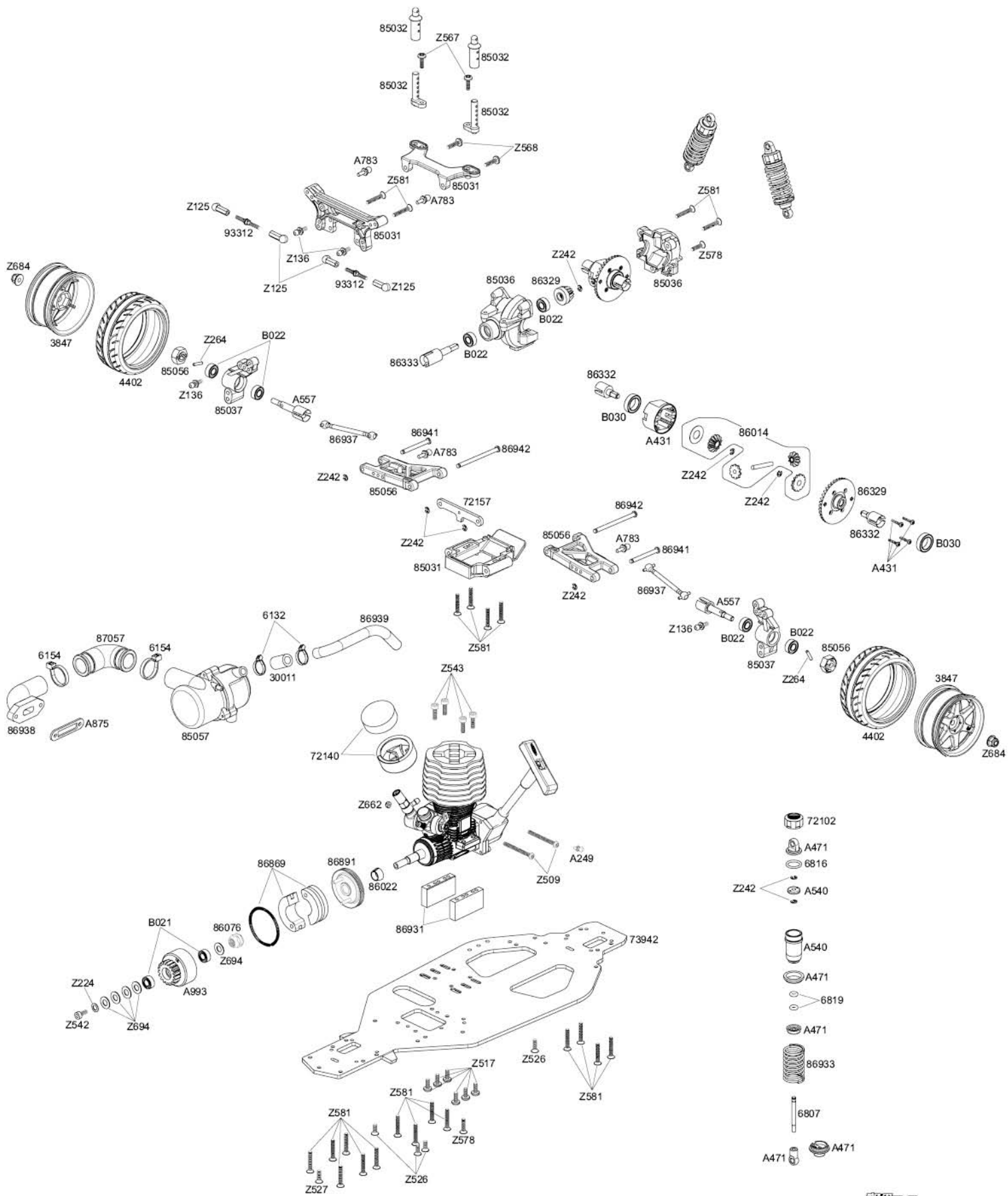

**En Parts List**

Parts #	Qty	Description	Parts #	Qty	Description
1504	1	GLOW PLUG COLD R5	86941	2	FLANGE SHAFT 3x30mm (BLACK)
3847	1	TE 37 WHEEL 26mm CHROME 6mm OFFSET	86942	2	FLANGE SHAFT 3x45mm (SILVER)
4402	1	SUPER DRIFT TIRE 26mm RADIAL (TYPE A)	86955	1	PRO SILICONE SHOCK OIL 30wt (60cc)
6122	10	BODY PIN (MEDIUM)	87021	1	FUEL TANK with PRIMER (75cc)
6132	20	PLASTIC STRAP (SMALL/BLACK)	87023	3	DIFF ADJUSTMENT SPRING 3x14x0.5mm
6154	10	NYLON STRAP (3.5x150mm/BLACK)	87057	1	SILICONE EXHAUST COUPLING 12X36mm (PURPLE)
6163	5	SERVO TAPE 20x100mm	93312	2	TURNBUCKLE 4-40x24mm
6274	1	PRECUT FOAM BUMPER GRAY (RS4)	93317	2	TURNBUCKLE 4-40x34mm
6807	2	SHOCK SHAFT 3x31mm	A249	4	BALL M2x3.8x4.5mm
6816	6	SILICONE O-RING S10	A280	4	FLANGE SHAFT SET 3x25mm/A284 3x30mm
6819	5	SILICONE O-RING P-3 (RED)	A281	4	FLANGE SHAFT SET 3x36mm/A282 3x42mm
6823	5	SILICONE O-RING 4.5x6.6mm (RED)	A396	1	SERVO SAVER SET (a,b)
15105	1	NITRO STAR G3.0 ENGINE with PULLSTART	A431	1	DIFF CASE (a,b)
15162	1	COMPOSITE ROTARY CARBURETOR COMPLETE (F2/6.5mm)	A471	2	SHOCK PARTS SET
30011	1	SILICONE EXHAUST TUBE	A540	2	HPI SPORTS SHOCK BODY (45-56mm)
50474	1	SILICONE TUBE 2x5x300mm	A556	2	AXLE 5x32mm (FRONT)
72001	2	PILOT SHAFT 4x30mm	A557	2	AXLE 5x38mm (REAR)
72102	2	SHOCK CAP 12xM13x0.8mm (PURPLE/ GROOVED)	A783	4	BALL 4.7x14mm (PURPLE ANODIZED)
72140	1	AIR CLEANER 30mm (a,b)	A838	4	FLANGE PIPE 3x4.5x5.5mm
72144	1	LINKAGE SET (a,b)	A875	5	EXHAUST GASKET
72148	1	BRAKE CAM SHAFT/PLATE SET (a,b)	A993	1	HEAVY DUTY CLUTCH BELL 18 TOOTH (1M)
72157	1	ARM BRACE SET (a,b)	B021	2	BALL BEARING 5x10x4mm
73942	1	MAIN CHASSIS	B022	2	BALL BEARING 5x11x4mm
75106	20	BODY CLIP (6mm/BLACK)	B030	2	BALL BEARING 10x15x4mm
76817	1	SPUR GEAR 47T (2 SPEED)	Z125	14	BALL CUP
85031	1	SHOCK TOWER/BUMPER SET (NITRO 3)	Z136	4	BALL END 4-40 (BLACK)
85032	1	BODY POST/LINK SET (NITRO 3)	Z150	1	ANTENNA PIPE SET
85036	1	GEARBOX SET (NITRO 3)	Z162	1	HEAVY WEIGHT GREASE (#100000/GEAR DIFF)
85037	1	REAR HUB SET (2 DEGREE/1 DEGREE)	Z164	1	HEAVY DUTY GREASE
85038	1	FRONT UPRIGHT SET (8 DEGREE/10 DEGREE)	Z224	10	WASHER M3x8mm
85039	1	SERVO HORN (for 50/50 THROW)	Z238	4	C CLIP 13mm
85055	1	UPPER DECK SET	Z242	20	E CLIP E2mm
85056	2	SUSPENSION ARM SET (190mm WIDTH)	Z264	10	PIN 2x10mm SILVER
85057	1	TUNED PIPE SET	Z282	4	STEP SCREW M3x14mm
86014	1	SPRINT GEAR DIFF BEVEL GEARS (13T, 10T) (a,b,c,d)	Z509	6	BUTTON HEAD SCREW M3x30mm
86022	1	COLLET 6x10mm	Z516	6	BINDER HEAD SCREW M3x10mm
86076	1	PILOT NUT 1/4-28x8.5mm (BLACK)	Z517	10	BINDER HEAD SCREW M3x8mm
86094	6	SCREW SHAFT M4x2.5x12mm (BLACK)	Z518	6	BINDER HEAD SCREW M3x12mm
86126	2	STANDOFF 7x25mm	Z526	6	FLAT HEAD SCREW M3x8mm
86329	1	HEAVY-DUTY FINAL GEAR SET (P1x36T/P1x14T) (a,b)	Z527	6	FLAT HEAD SCREW M3x10mm
86331	1	HEAVY-DUTY CUP JOINT 5x10x18mm (D CUT/SILVER)	Z542	12	CAP HEAD SCREW M3x8mm
86332	2	HEAVY-DUTY DIFF SHAFT (SILVER)	Z543	6	CAP HEAD SCREW M3x10mm
86333	2	HEAVY-DUTY GEAR SHAFT 5x37mm (SILVER)	Z561	6	TP. FLANGED SCREW M3x10mm
86869	1	CLUTCH SHOE/SPRING SET (a,b)	Z567	10	TP. BINDER HEAD SCREW M3x10mm
86891	1	FLYWHEEL 7x33x7mm	Z568	10	TP. BINDER HEAD SCREW M3x12mm
86931	1	ENGINE MOUNT	Z569	10	TP. BINDER HEAD SCREW M3x15mm
86933	2	SHOCK SPRING 13.8x27x1.5mm 8.5COILS (METALLIC RED)	Z578	10	TP. FLAT HEAD SCREW M3x12mm
86934	1	CUP JOINT 6x10x50mm	Z581	10	TP. FLAT HEAD SCREW M3x18mm
86935	1	CENTER DRIVE SHAFT 6x14mm	Z653	6	NUT M3
86936	1	CENTER DRIVE SHAFT 6x112mm	Z662	4	LOCK NUT M2
86937	1	DRIVE SHAFT 6x47mm	Z684	4	FLANGED LOCK NUT M4
86938	1	EXHAUST HEADER	Z694	10	WASHER M5x10x0.5mm SILVER
86939	1	EXHAUST PIPE 8x75mm	Z699	2	WASHER 7x12x0.8mm BLACK
86940	1	SPUR GEAR HUB	Z721	4	SET SCREW M4x4mm